

INSTRUCTIONS FOR USING Split Front

WITH AN EMBROIDERY SEW DISK

(If handsewing, the instructions for placement are on the back)

BEFORE YOU START: DESIGN WILL BE STRAIGHT UNLESS 15° ROTATION SPECIFIED

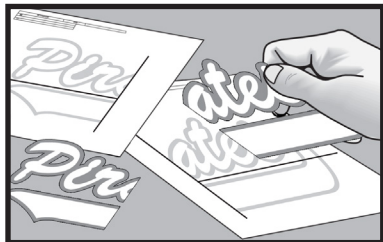

You received two paper proofs—one for each side of your split front jersey. The paper proofs show the stitch file at the actual size. Make sure your appliqué matches the stitch file exactly by laying the appliqué pieces on top of the paper proof. The proofs also indicate the number of color changes and appliqué stops in the design.

FOR PROPER ALIGNMENT:

The double hoop or two hooping method is recommended. A successful application can be achieved if the garment hooping/setup is done correctly.

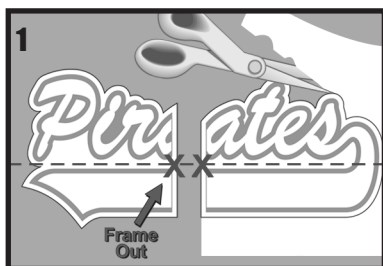

1. Please note: On the proofs, the origin point is where the cross hairs intersect. Use the proofs as templates for correct alignment. Trim the templates to create a pattern that will easily fit the garment.
(Idea: laminate the pattern pieces.)

VELCRO® BUTTON PLACEMENT:

*Velcro buttons included only in Any Word. Any Way.™ overlap split front orders. Remove button **IF** necessary. Baste stitch the Velcro (with hooks) into position on the underside of the buttonhole before embroidering that half of the garment.

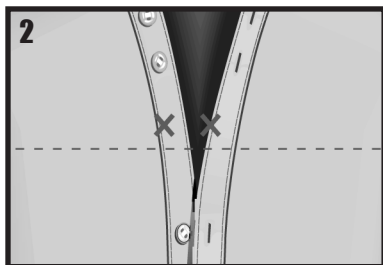

2. With a pin, poke a hole at the origin in your paper pattern. Lay your garment flat. Align paper proof on the button hole side along the placket edge. Slide the other half of the proof under the placket with the buttons until it lines up with the first half. You may want to tape the pattern pieces in place while you mark the origin. Rub tailor's chalk or marking pen over the origin pin holes that you made.

THE 2ND VELCRO PIECE (with loops) will be sewn on **AFTER** your appliqué is fully sewn and will replace your button.
(Use the 1st Velcro piece as a guide for placement)

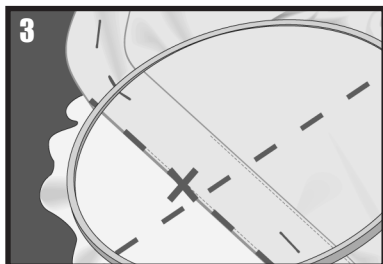

3. To guarantee a straight, horizontal alignment, use the horizontal lines on the paper proof to draw a chalk line going across the shirt. Mark the hoops to ensure horizontal alignment.



4. Make sure the paper proof and markings are correct by buttoning the jersey and viewing the alignment while buttoned.

Hotronix is a registered trademark of Stahls' ID Direct with one or more patents or patents pending. © Stahls' ID Direct 2012

All technical information and recommendations are based on tests we believe to be reliable. However, we cannot guarantee performance for conditions not under manufacturer's control.

Before using, please determine the suitability of product for its intended use. The user assumes all risk and liability whatsoever in connection with the use of this product.

Seller's and manufacturer's only obligation shall be to replace such quantity of the product proved to be defective by manufacturer.

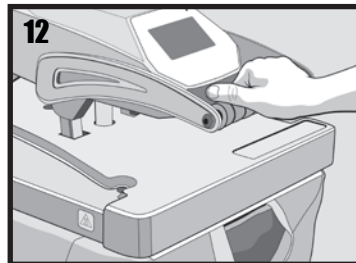
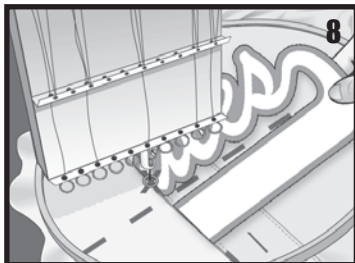
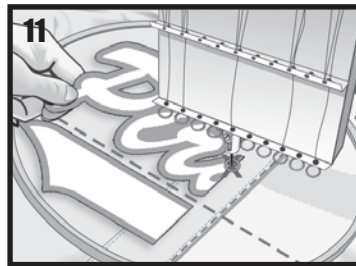
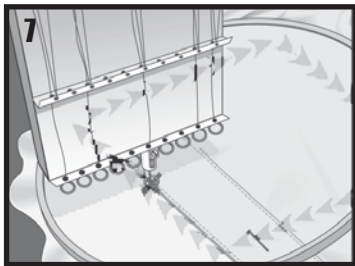
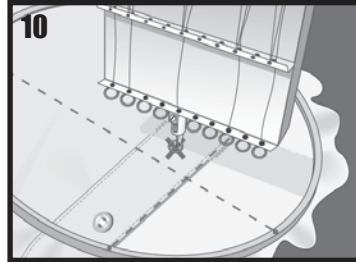
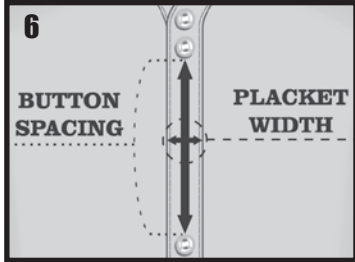
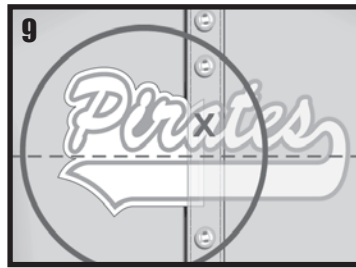
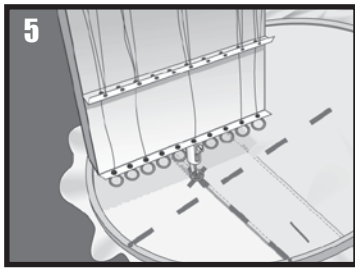

GETTING READY TO SEW:

5. With the top half (the side without buttons) of the garment already hooped, place the hoop into the embroidery machine. (Your point of origin will **NOT** be centered—rather it will be over to one side of the hoop).
6. Load the first design, from the disk, into your embroidery machine. Make certain your needle is over the origin point you marked on the garment.
7. **BEFORE** you start sewing, do a frame trace of the design to ensure proper sewing in the hoop.
8. The file will begin with a straight stitch. If it does not line up against the edge of the shirt, make adjustments to ensure the shirt is straight in the hoop. Sew out running stitch and position appliqué (use Thermo-Tape, spray adhesive or hand iron to tack design down). Finish sewing your design on this side of the split front jersey. After sewing, remove the hoop.
9. Check alignment of design by buttoning the jersey and sliding the opposite side of the proof under the placket until it lines up with the sewn side.
10. Load the second design, from the disk, into your embroidery machine. Move the needle to the origin point and do another frame trace. (The origin point on this side will fall between the edge and where the buttons are sewn, not at the edge).
11. Sew out running stitch, position appliqué, and finish sewing your design on this side of the split front jersey. After sewing, remove the hoop.
12. Heat sealing prevents puckering due to shrinkage. Refer to product tech sheets.
You are done—Proper alignment in your hoop gave you a perfect split front!

ALIGNMENT AND APPLICATION INSTRUCTIONS FOR HEAT-APPLIED MATERIALS AND MATERIALS TO BE HAND-SEWN:

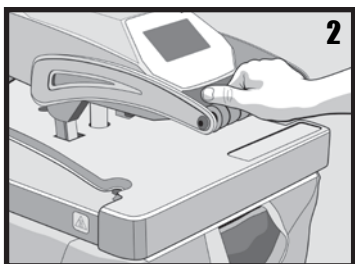

1. On the buttonhole side, align the design against the placket edge. Slide the opposite side with the buttons, horizontally under the placket, until it lines up with the other half. Make sure design is aligned correctly by viewing the garment while buttoned.
(TIP: Use Thermo-Tape or spray adhesive to tack design onto garment.)
2. Lay the garment openings side by side on the heat seal machine, heat apply design according to product tech sheets and use a cover sheet.
(TIP: For button down jerseys, use a Heat Printing Pillow to help even out the garment surface during heat application.)

Hotronix is a registered trademark of Stahls' ID Direct with one or more patents or patents pending. © Stahls' ID Direct 2012

All technical information and recommendations are based on tests we believe to be reliable. However, we cannot guarantee performance for conditions not under manufacturer's control. Before using, please determine the suitability of product for its intended use. The user assumes all risk and liability whatsoever in connection with the use of this product.

Seller's and manufacturer's only obligation shall be to replace such quantity of the product proved to be defective by manufacturer.